



Revised Thruster Modification Cut Out Dimension

MD Helicopters, Inc. (MDHI) has found that on some aircraft the thruster cut out dimension published in SB900-099 is not sufficient to give clearance for the thruster control rod. To make sure there is correct clearance, use the cut out dimension that is shown in Figure 1.

For further assistance, contact the Field Service Department at MDHI, Mesa, Arizona. Telephone 1-800-388-3378 or (480) 346-6387. DATAFAX: (480) 346-6813.

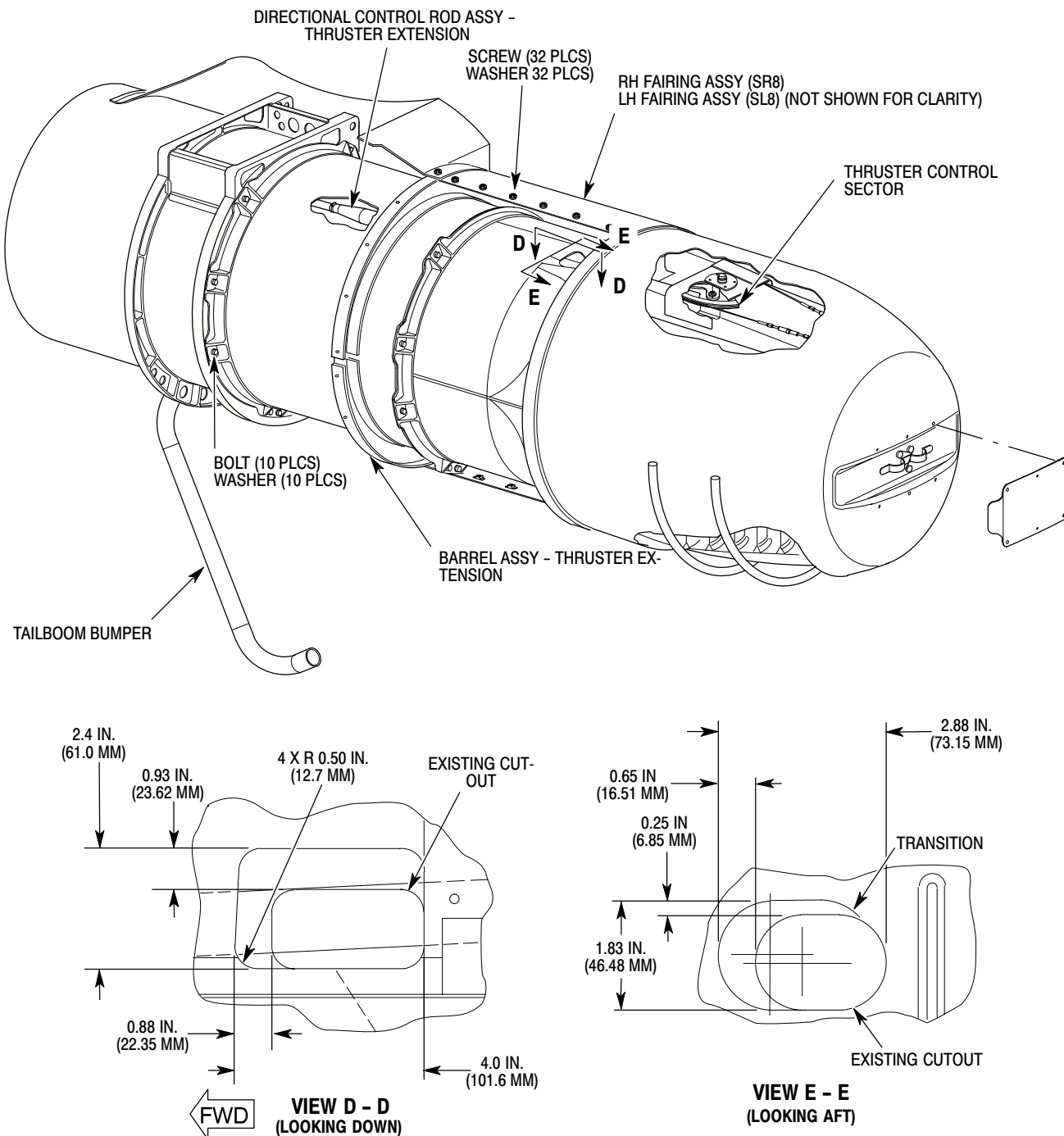

Figure 1. Thruster Modification