



SERVICE BULLETIN

DATE: 12 MARCH 1997

PAGE 1 OF 5

MANDATORY

* Supersedes Service Bulletin SB900-039R1, dated 16 January 1997.

VSCS BELLCRANK, MID-AFT STRUT AND DECK FITTING SERIALIZATION

1. PLANNING INFORMATION:

A. Aircraft Affected:

All McDonnell Douglas Helicopter Systems (MDHS) MD900 Series Helicopters, serial numbers 00002 thru 00048.

B. Assembly/Components Affected by this Notice:

Vertical Stabilizer Control System (VSCS) Bellcrank Assembly (P/N 900F2341712-101), the Strut Assembly, Mid-Aft Truss (P/N 900F2401300-103), the Strut Assembly, Mid-Fwd Truss (P/N 900F2401200-102), the Deck Fitting Assembly, Fwd (P/N 900F2401500-103) and the Deck Fitting Assembly, Aft (P/N 900F2401600-103).

NOTE: The 900F2341713-101 bellcrank arm, is a component of the 900F2341712-101 VSCS bellcrank assembly. For spares ordering purposes, the 900F2341712-101 assembly should be ordered. When replacing the early configuration 900FP341712-103 VSCS bellcrank assembly, replacement hardware must be ordered (Ref. Figure 1 for descriptions of the different configurations). Additionally, the latest configuration (P/N 900FP341722-101) "Karon" bellcrank (configuration C) is also shown.

C. Reason:

The VSCS bellcrank arm, the mid-aft and mid-fwd truss strut and the forward and aft deck fitting assemblies have been added to the life-limited parts list. Therefore, these parts must be serialized. Failure to comply with the requirements of this Bulletin may result in parts remaining in service after their life-limit expires. This may result in parts failing in service.

NOTE: Refer to CSP-900RMM-2, Section 04-00-00, for the life-limited times of the affected parts. The "Karon" bellcrank (P/N 900FP341722-101) is not a life-limited part.

D. Description:

Procedures in this Bulletin provide owners and operators with information pertaining to applying serial numbers to specific components in those helicopters listed above.

E. FAA Approval:

The technical design aspects of this Service Bulletin are FAA Approved.

F. Manpower:

0.5 man-hours

G. Time of Compliance:

The requirements of this Bulletin shall be accomplished within the next 100 hours of helicopter operation or no later than 30 April 1997.

H. Warranty Policy:

N/A

MANDATORY



DATE: 12 MARCH 1997
 PAGE 2 OF 5

SERVICE BULLETIN

MANDATORY MANDATORY MANDATORY

I. Tooling:

N/A

J. Weight and Balance:

N/A

K. Electrical Load Data:

N/A

L. Other Publications Affected:

Rotorcraft Maintenance Manual (CSP-900RMM-2, Section 04-00-00).

2. ACCOMPLISHMENT INSTRUCTIONS:

- (1). Apply the serial numbers listed below to the applicable LH and RH VSCS bellcranks, the mid-aft and mid-fwd strut assemblies and the fwd and aft deck fitting assemblies using permanent ink or paint. When dry, apply a clear coat over the serial number.

3. DISPOSITION OF PARTS REMOVED:

N/A

4. COMPLIANCE RECORD:

Record compliance to this Service Bulletin in the Compliance Record section of the helicopter Log Book and create item component record cards for items serialized. Additionally, contact MDHS Field Service Department to report compliance to this Service Bulletin.

5. POINTS OF CONTACT:

For further assistance, contact your local MDHS Field Service Representative (refer to the Business Development and Customer Support handbook for address and telephone numbers) or contact the Field Service Department at MDHS, Mesa, Arizona. Telephone: 1-800-388-3378 or (602) 891-6342. DATAFAX: (602) 891-6782.

Serial Number To Be Applied			
Aircraft Ser. No.	VSCS Bellcrank Assembly 900F2341712-101 and 900FP341712-103		Strut Assy, Mid-Aft 900F2401300-103
	LH VSCS	RH VSCS	
0002	009999-0001	009999-0002	See Note 1
0008	009999-0003	009999-0004	See Note 1
0010	009999-0005	009999-0006	See Note 1
0011	009999-0007	009999-0008	See Note 1
0012	009999-0009	009999-0010	See Note 1

MANDATORY MANDATORY MANDATORY



SERVICE BULLETIN

DATE: 12 MARCH 1997

PAGE 3 OF 5

/// MANDATORY ////////////////////////////////////// MANDATORY ////////////////////////////////////// MANDATORY ///

Serial Number To Be Applied (Cont.)			
Aircraft Ser. No.	VSCS Bellcrank Assembly 900F2341712-101 and 900FP341712-103		Strut Assy, Mid-Aft 900F2401300-103
	LH VSCS	RH VSCS	
0013	009999-0011	009999-0012	009999-0006
0014	009999-0013	009999-0014	009999-0007
0015	009999-0015	009999-0016	009999-0008
0016	009999-0017	009999-0018	009999-0009
0017	009999-0019	009999-0020	009999-0010
0018	009999-0021	009999-0022	009999-0011
0019	009999-0023	009999-0024	009999-0012
0020	009999-0025	009999-0026	009999-0013
0021	009999-0027	009999-0028	009999-0014
0022	009999-0029	009999-0030	009999-0015
0023	009999-0031	009999-0032	009999-0016
0024	009999-0033	009999-0034	009999-0017
0025	009999-0035	009999-0036	009999-0018
0026	009999-0037	009999-0038	009999-0019
0027	009999-0039	009999-0040	009999-0020
0028	009999-0041	009999-0042	009999-0021
0029	009999-0043	009999-0044	009999-0022
0030	009999-0045	009999-0046	009999-0023
0031	009999-0047	009999-0048	009999-0024
0032	009999-0049	009999-0050	009999-0025
0033	009999-0051	009999-0052	009999-0026
0034	009999-0053	009999-0054	009999-0027
0035	009999-0055	009999-0056	009999-0028
0036	009999-0057	009999-0058	009999-0029
0037	009999-0059	009999-0060	009999-0030

/// MANDATORY ////////////////////////////////////// MANDATORY ////////////////////////////////////// MANDATORY ///

DATE: 12 MARCH 1997

PAGE 4 OF 5

SERVICE BULLETIN

MANDATORY  **MANDATORY**  **MANDATORY** 

Serial Number To Be Applied (Cont.)			
Aircraft Ser. No.	VSCS Bellcrank Assembly 900F2341712-101 and 900FP341712-103		Strut Assy, Mid-Aft 900F2401300-103
	LH VSCS	RH VSCS	
0038	009999-0061	009999-0062	009999-0031
0039	009999-0063	009999-0064	009999-0032
0040	009999-0065	009999-0066	009999-0033
0041	009999-0067	009999-0068	009999-0034
0042	009999-0069	009999-0070	009999-0035
0043	009999-0071	009999-0072	009999-0036
0044	009999-0073	009999-0074	009999-0037
0045	009999-0075	009999-0076	009999-0038
0046	009999-0077	009999-0078	009999-0039
0047	009999-0079	009999-0080	009999-0040
0048	009999-0081	009999-0082	009999-0041

NOTE 1 - Aircraft 00002 thru 00012 are equipped with 900F2401300-101 Mid-Aft Strut Assemblies. These strut assemblies were previously serialized, therefore, no action is required. Refer to CSP-900RMM-2, Section 04-00-00, for retirement time of this part.

Serial Number To Be Applied			
Aircraft Serial No.	Strut Assembly, Mid-Fwd Truss (900F2401200-102)	Deck Fitting Assembly, Fwd (900F2401500-103)	Deck Fitting Assembly, Aft (900F2401600-103)
0002	009999-0001	009999-0001	009999-0001
0008	009999-0002	009999-0002	009999-0002
0010	009999-0003	009999-0003	009999-0003
0011	009999-0004	009999-0004	009999-0004
0012	009999-0005	009999-0005	009999-0005

MANDATORY  **MANDATORY**  **MANDATORY** 

SERVICE BULLETIN

DATE: 12 MARCH 1997

PAGE 5 OF 5

MANDATORY **MANDATORY** **MANDATORY**

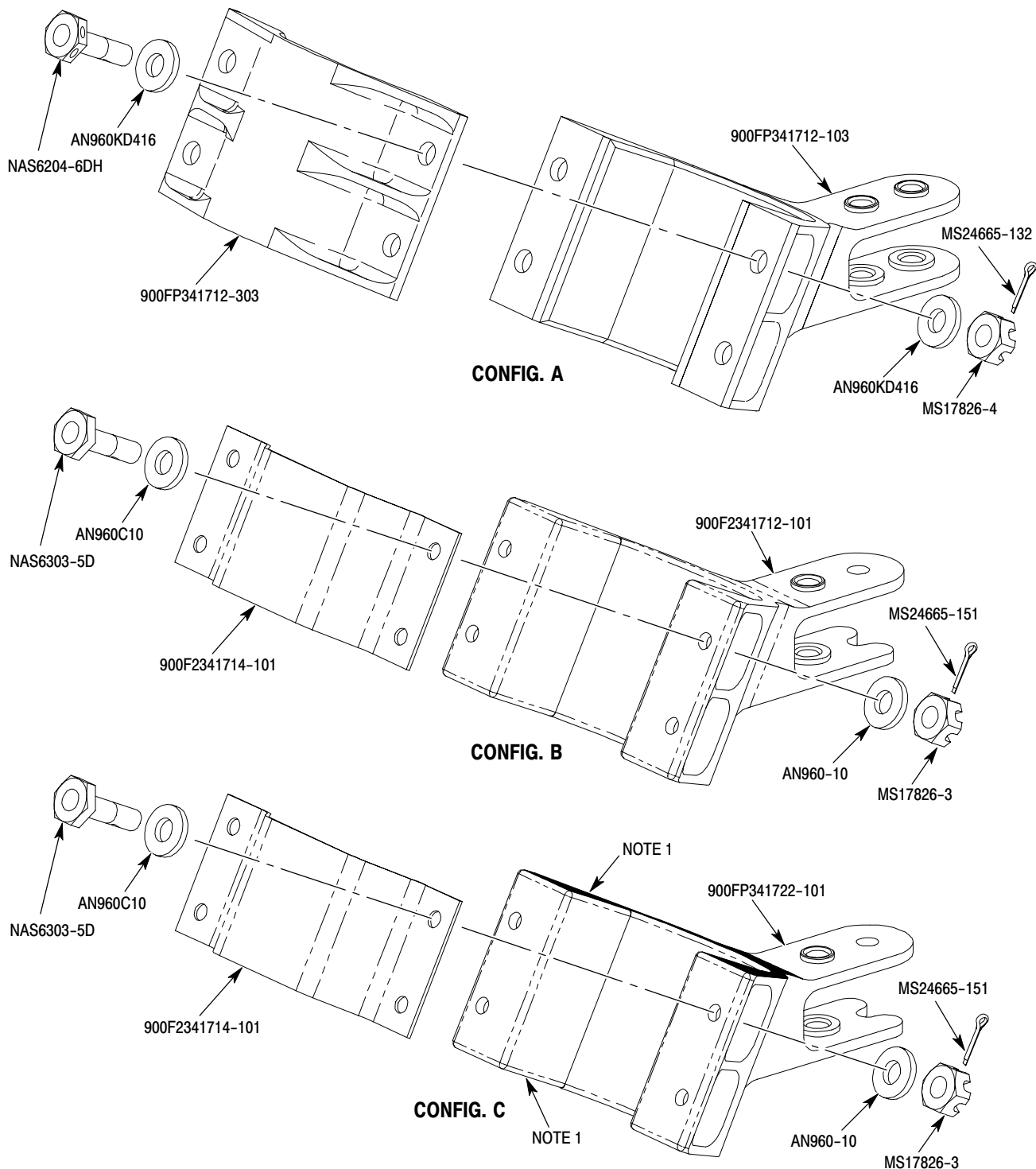

NOTE 1: "KARON" LINER IS ON BOTH UPPER AND LOWER SURFACE OF BELLCRANK.

9B67-054

Figure 1. Bellcrank Configurations

MANDATORY **MANDATORY** **MANDATORY**