



SERVICE LETTER

DATE: 13 SEPTEMBER 2005
PAGE 1 OF 2

ANTI - TORQUE CONTROL PEDAL SEPARATION

This Service Information Letter is issued to inform owners and operators of MD900 helicopters of an accident where an anti-torque control pedal separated from the pedal shaft assembly. This incident is under investigation. A possible cause may be poor penetration on the fillet weld on the pedal support plate and fatigue (Ref. Figure 1).

If a pedal should separate from the shaft, anti-torque control can be maintained by the pilot placing his foot on the pedal shaft to maintain directional control. If this occurs in flight, perform a normal landing as soon as possible.

SERVICE LETTER

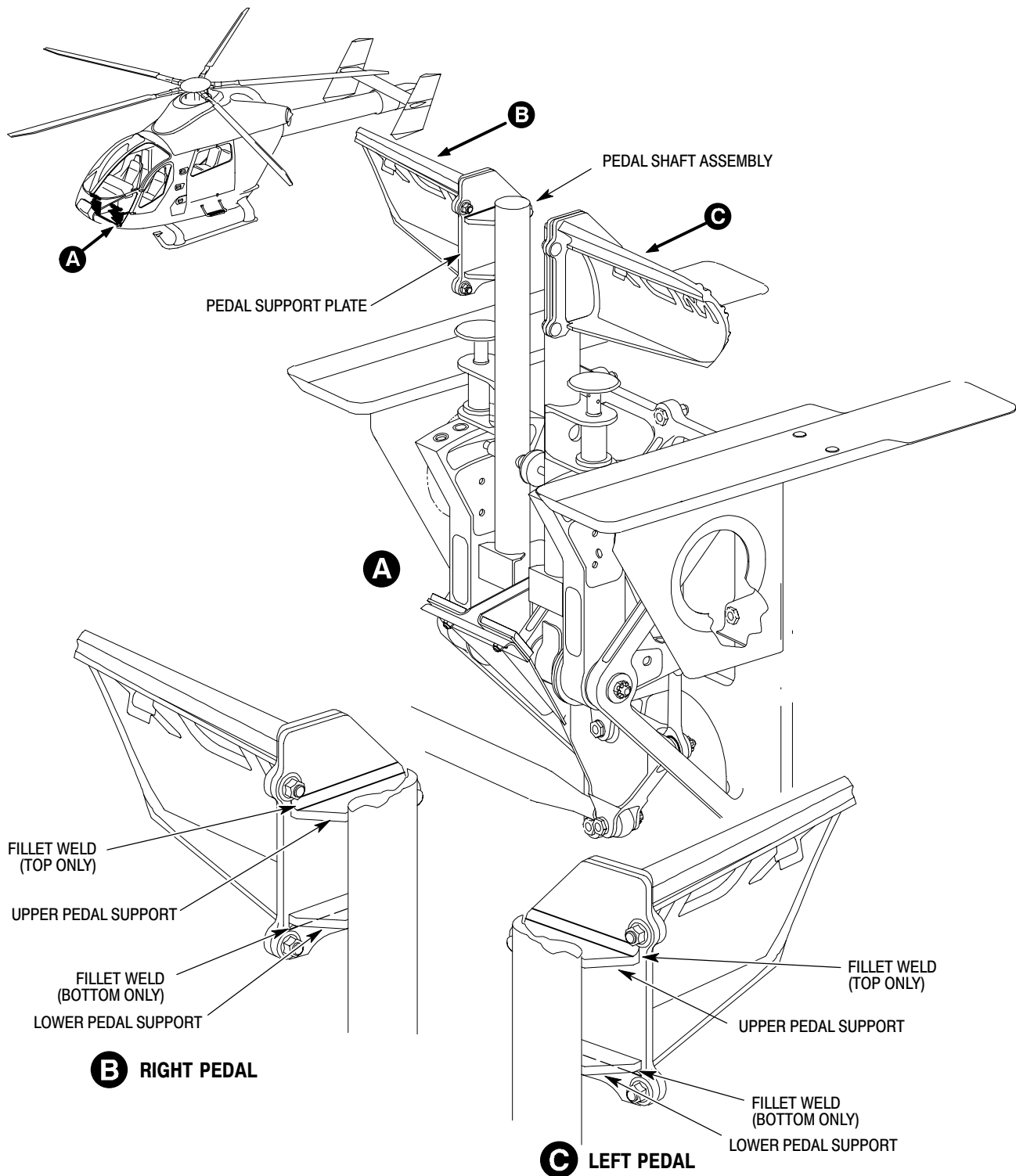

Figure 1. Anti-Torque Control Pedal Installation

Copyright © 1999 - 2005 by MD Helicopters, Inc.
This document may be reproduced and distributed provided no fee is charged,
the text is not modified, and this copyright notice is included.