



SERVICE LETTER

DATE: 23 JANUARY 1998

PAGE 1 OF 2

* Supersedes SL900-025 dated 08 January 1997. Reason for Revision: To allow installation of a spacer under the door handle to provide the handle better clearance from adjacent structure.

CABIN DOOR HANDLE INSTALLATION

At the discretion of Boeing MD900 owners/operators, a cabin door handle may be installed to aid in closing the cabin door. Instructions in this Letter provide customers with details to fabricate a spacer, handle and install the handle and spacer to the cabin door.

1. PLANNING INFORMATION:

A. Material/Part Availability:

All parts may be locally purchased from commercial sources.

REPLACEMENT PARTS/SUPPLIES			
Nomenclature	Part No.	Qty.	Source
Screw	HS4727-3-18 (or equivalent)	4	Commercial
Polyetherimide Rod 1" Diameter	McMaster and Carr P/N - 8688K76	12 in.	Commercial
Spacer, aluminum (field fabricate as shown in Figure 1.)	Aluminum plate, 0.375 in. thick	A/R	Commercial

2. ACCOMPLISHMENT INSTRUCTIONS:

(Ref. Figure 1)

The following tasks are typical for Left and Right Cabin Doors.

- (1). Fabricate handle per Figure 1, deburr holes and radius all edges.
- (2). Fabricate aluminum spacer as shown in Figure 1.
- (3). Remove screws from cabin door fitting indicated in Figure 1 and discard.
- (4). Install and tighten replacement screws, handle and spacer into screw holes of cabin door fitting indicated in Figure 1.

3. COMPLIANCE RECORD:

Record compliance to this Service Letter in the Compliance Record section of the helicopter Log Book.

DATE: 23 JANUARY 1998

PAGE 2 OF 2

SERVICE LETTER

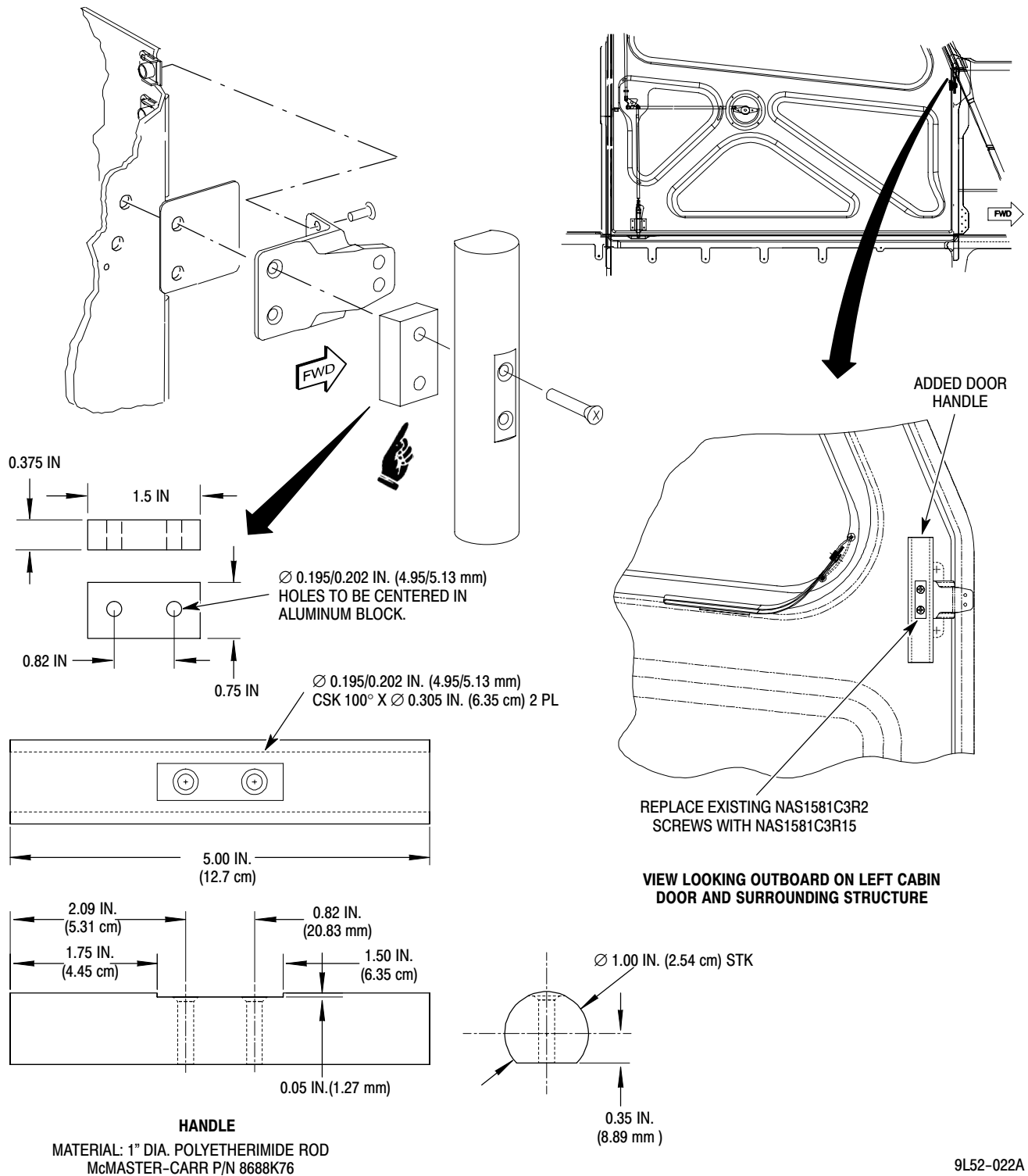

Figure 1. Cabin Door Handle Installation