



# SERVICE LETTER

DATE: 11 NOVEMBER 1995

PAGE 1 OF 2

**SUBJECT:** PEDAL RETURN SPRINGS

**MODELS AFFECTED:** All McDonnell Douglas Helicopter Systems (MDHS) MD900 series helicopters.

The purpose of this letter is to inform all MD900 helicopter owners and operators to remove the directional pedal return springs at their option.

MDHS engineering has determined the pedal return springs (which return the pedals to their full aft position during pedal adjustments) are not required. Aircraft in the future (S/N's 35 and subsequent) will be equipped with a new or re-identified pedal assembly without the provisions for the pedal return springs.

Owners and operators may continue to operate the aircraft with the return springs installed or, may remove the springs, arbors and attaching hardware at any time during normal maintenance practices.

If the springs are removed, the existing pedal assemblies should be re-identified as a 900C6012007 modified part using contrasting ink or paint.

A handwritten signature in black ink, appearing to read 'John Reagan'.

John Reagan, Dept. Manager,  
Commercial Customer Support  
McDonnell Douglas Helicopter Systems

**POINTS OF CONTACT:** For further assistance, contact the Field Service Department at MDHS, Mesa Arizona. Telephone: 1-800-388-3378 or (602) 891-6342. DATAFAX: (602) 891-6782.

# SERVICE LETTER

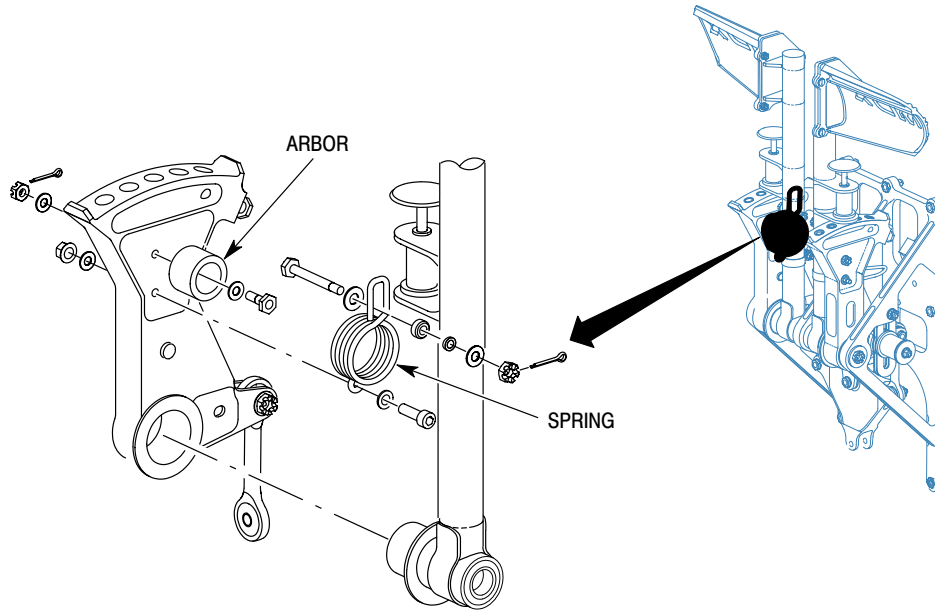

9L67-001

Figure 1. Pedal Return Springs Removal