



TECHNICAL BULLETIN

DATE: 03 OCTOBER 1977
PAGE 1 OF 3

INSTALLATION OF AUXILIARY DRAIN VALVE, FUEL SYSTEM INSTALLATION – PN 369H92255 DRAIN KIT

1. PLANNING INFORMATION:

A. Models Affected:

500D Model 369D Helicopter Serial No. 0001D thru 0129D

B. Preface:

The information given in this Service Information Notice lists a procedure for incorporating an auxiliary drain valve at the engine fuel pump filter housing to facilitate draining of water from the filter.

C. Time of Compliance:

At owners and operators discretion

D. Weight and Balance:

Weight and balance not affected.

E. Reference Publications:

500D Series - Model 369D Basic HMI Volume I, Issued 15 September 1976

When ordering, specify PN 369H92255 drain kit which includes the following:

REPLACEMENT PARTS/SUPPLIES			
Nomenclature	Part No.	Qty.	Source
Drain kit	369H92255	1	HH
Tube	369A8100-3	1	HH
Tube	369A8100-5	1	HH
Tube	369A8100-7	1	HH
Tee	6151-0250	1	HH
Valve	CAV-170H-04	1	HH
Packing	MS29512-04	1	HH
Strap	MS3367-1-9 or equivalent	1	Commercial
Tyrap	TY-25M or equivalent	1	Thomas and Betts Elizabeth, NJ

MATERIAL	
Nomenclature	Source
Lockwire (MS20995N32)	Commercial

DATE: 03 OCTOBER 1977
PAGE 2 OF 3

TECHNICAL BULLETIN

2. PROCEDURE

- (1). Turn off all electrical switches; disconnect battery, and any external power from helicopter.
- (2). Gain access to engine accessory section and fuel drain firewall fitting. (See Figure 1.)
- (3). Remove lockwire securing existing drain plugs on fuel pump filter housing; remove one drain plug and install new CAV-170H-04 valve with MS29512-04 packing as shown. Secure new drain valve and remaining drain plug with lockwire.
- (4). Disconnect existing 369A8010-85 overboard drain tube from drain valve on firewall fitting. and from tie base on firewall; remove -85 tube.
- (5). Install new 369A8100-7 drain tube on drain valve at firewall fitting and secure with lockwire as shown.
- (6). Install new 6151-0250 tee at other end of -7 drain tube and secure with lockwire; install new 369A8100-5 overboard drain tube on tee as shown and secure with lockwire.
- (7). Install new 369A8100-3 drain tube on tee as shown and secure with lockwire; install other end of -3 tube on new drain valve installed on fuel pump filter housing and secure with lockwire.
- (8). Secure -3 drain tube to existing 369H8102 hose assembly as shown, using MS3367-1-9 strap. Allow sufficient slack in -3 tube to permit unrestrained movement of drain valve. Also position tube so that no fluid traps exist.
- (9). Secure -7 tube at existing tie base on firewall, using Tyrap as shown. Allow sufficient slack in tube to permit unrestrained movement of drain valve.
- (10). Route -5 overboard drain tube down through existing grommet in underside of fuselage; allow drain tube to extend 0.00 to 0.12 inch beyond grommet.
- (11). Check installation of auxiliary drain valve for discrepancies.
- (12). Perform operational check of fuel drain system. (Refer to Basic HMI.)
- (13). Record compliance with this Service Information Notice in Compliance Record of Helicopter Log Book.

TECHNICAL BULLETIN

DATE: 03 OCTOBER 1977
PAGE 3 OF 3

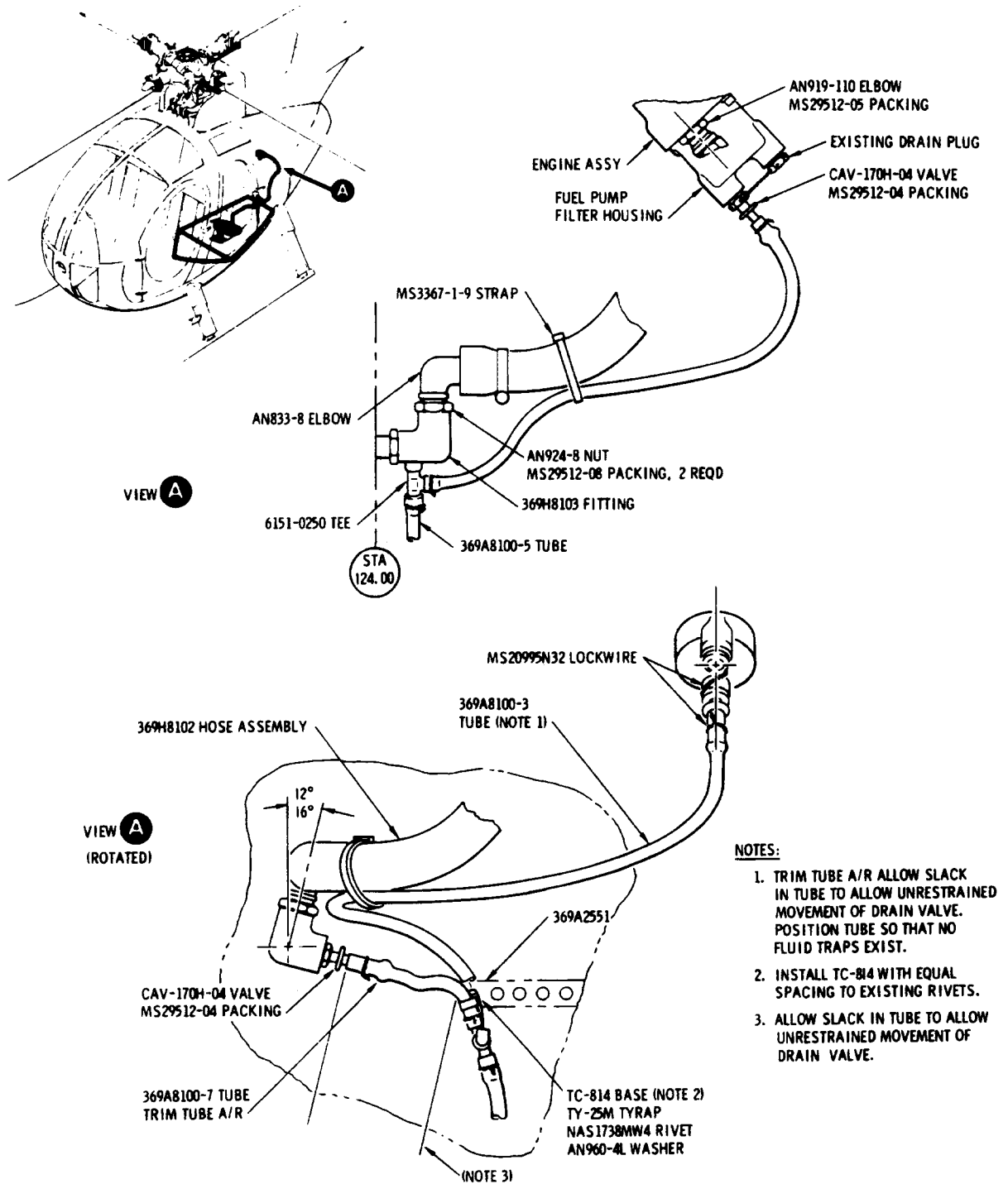

NOTES:

1. TRIM TUBE A/R ALLOW SLACK IN TUBE TO ALLOW UNRESTRAINED MOVEMENT OF DRAIN VALVE. POSITION TUBE SO THAT NO FLUID TRAPS EXIST.
2. INSTALL TC-814 WITH EQUAL SPACING TO EXISTING RIVETS.
3. ALLOW SLACK IN TUBE TO ALLOW UNRESTRAINED MOVEMENT OF DRAIN VALVE.

88-222

Figure 1. Installation of auxiliary drain valve, engine fuel system - Drain Kit PN 369H2255