



DN-183.2\*  
EN-75.2\*  
FN-62.2\*

# SERVICE BULLETIN

DATE: 27 JANUARY 1993  
PAGE 1 OF 4

**/// MANDATORY ////////////////////////////////////// MANDATORY ////////////////////////////////////// MANDATORY ///**

\* Supersedes Service Information Notices DN-183.1, EN-75.1 and FN-62.1, dated 26 August 1992.

The revision deletes the blade removal and inspection requirements of PART I. The 369D21100-515 and 369D21102-501 main rotor blades must be inspected per the requirements of DN-51.6, EN-42.4 and FN-31.4, dated 27 January 1993.

## MAIN ROTOR BLADE REPLACEMENT

### 1. PLANNING INFORMATION:

#### A. Summary:

The requirements of PART I have been deleted.

PART II of this notice provides instructions to remove the 369D21100-515 and 369D21102-501 main rotor blades and send them to MDHC for rework to 369D21100-516A and 369D21102-503A and/or replace them with 369D21100-516, 369D21100-516A or 369D21100-517 (if available) and 369D21102-503, 369D21102-503A or 369D21102-517 (if available) main rotor blades, as applicable.

#### B. Purpose:

To prevent the possibility of a main rotor blade root fitting crack.

**WARNING** If sudden, unusual or excessive vibrations should occur during flight, a precautionary landing must be made. No further flights shall be attempted until the cause of the vibration has been identified and corrected.

#### C. Models Affected:

All 369D, 369E and 369F/FF series helicopters equipped with 369D21100-515 or 369D21102-501 series main rotor blades.

#### D. Time of Compliance:

PART I has been deleted.

PART II shall be accomplished within 600 hours of main rotor blade operation from the original issue date of this notice (20 May 1992) or no later than June 30, 1993.

#### E. FAA Approval:

The design engineering aspects of this Notice have been shown to comply with the applicable Federal Aviation Regulations, and are FAA Approved.

#### F. Assembly/Components Affected by this Notice:

All 369D21100-515 and 369D21102-501 main rotor blades.

**(I)** Denotes portion of text added or revised.

**/// MANDATORY ////////////////////////////////////// MANDATORY ////////////////////////////////////// MANDATORY ///**



# SERVICE BULLETIN

/// MANDATORY ////////////////////////////////////// MANDATORY ////////////////////////////////////// MANDATORY ///

## G. Weight and Balance:

N/A

## H. Reference Publications:

369D/E/F/FF HMI (CSP-HMI-2) Revised 20 January 1992

REPLACEMENT PARTS			
Nomenclature	Part No.	Qty.	Source
Main Rotor Blade	369D21100-516 or 369D21100-516A	A/R	MDHC
Main Rotor Blade	369D21102-503 or 369D21102-503A	A/R	MDHC

## 2. AIRCRAFT INSPECTION AND/OR REWORK REQUIREMENTS:

### A. PART I - The requirements of PART I have been deleted.

### B. PART II - Rework/Replacement of Main Rotor Blades

- (1). Remove all 369D21100-515 (369D/E) and 369D21102-501 (369F/FF) main rotor blades per the HMI.
- (2). Install 369D21100-516A, 369D21100-516, 369D21100-517 (if available) (369D/E) or 369D21102-503A, 369D21102-503, 369D21102-517 (if available) (369F/FF) main rotor blades per the HMI.
- (3). Send removed M/R blades to MDHC for rework to the 369D21100-516A or 369D21102-503A configuration, as applicable, following the procedures outlined below:
  - (a). Inspect M/R blades for serviceability per the HMI (section 62-10-00, pages 601-610 and 801-810 and all applicable Service Information Notices.

**NOTE:** MDHC WILL NOT REWORK ANY UNSERVICEABLE M/R BLADES OR BLADES WITH NON-STANDARD REPAIRS OR ALTERATIONS WITHOUT THE PROPER APPROVAL DOCUMENTS. ALL HISTORICAL RECORDS MUST BE SENT WITH EACH BLADE FOR MDHC TO PERFORM THE REWORK.

- (b). Send affected M/R blades to be reworked to MDHC, Mesa. The proper address is 5000 E. McDowell Road, Mesa, AZ 85205. Attention: Mr. Richard Head, Warranty and Repair Department.
- (c). Upon receiving M/R blades, MDHC will perform a receiving inspection of each blade. On blades that do not pass the inspection, the customer will be contacted for disposition of the blade.

/// MANDATORY ////////////////////////////////////// MANDATORY ////////////////////////////////////// MANDATORY ///



DN-183.2\*  
EN-75.2\*  
FN-62.2\*

# SERVICE BULLETIN

DATE: 27 JANUARY 1993  
PAGE 3 OF 4

**/// MANDATORY ////////////////////////////////////// MANDATORY ////////////////////////////////////// MANDATORY ///**

- (4). MDHC is offering operators two options for rework. There will be no charge to the operator for the main rotor blade rework.

**NOTE: OPTION #1:** Send M/R blades to MDHC, Mesa, Arizona, for rework. The operator will pay shipping charges to Mesa per MDHC standard warranty policy. MDHC will rework blades and ship them back to the operator. MDHC will pay shipping charges from Mesa back to the operator, the same way they were shipped to Mesa. MDHC will credit 4.0 hours labor to remove, install and track the main rotor blades. This work must be performed by an authorized MDHC Service Center.

**OPTION #2:** Send M/R blades to MDHC, Mesa, Arizona, for rework. The operator will pay shipping charges to Mesa per MDHC standard warranty policy. While the blades are being reworked in Mesa, MDHC will schedule loaner blades until the reworked blades are returned to the operator. MDHC will pay for shipping the loaner blades and the operators will not be charged for the flight time. MDHC will credit 4.0 hours labor to remove, install and track the loaner main rotor blades. MDHC will pay shipping charges for the reworked blades from Mesa back to the operator (same way) and 4.0 hours labor to install and track the reworked main rotor blades. This work must be performed by an authorized MDHC Service Center.

**NOTE:** Blades will be reidentified to 369D21100 -516A and 369D21102-503A respectively.

### 3. COMPLIANCE RECORD:

Record compliance with **PART II** of this Notice in the compliance record section of the helicopter Log Book.

### 4. POINTS OF CONTACT:

For further information, contact your local MDHC Field Service Representative (refer to the latest revision of the Product Support handbook for address and telephone numbers) or contact the Field Service Department at MDHC, Mesa, Arizona. Telephone: 1-800-388-6342 or (602) 891-6342.

**/// MANDATORY ////////////////////////////////////// MANDATORY ////////////////////////////////////// MANDATORY ///**

# SERVICE BULLETIN

MANDATORY MANDATORY MANDATORY

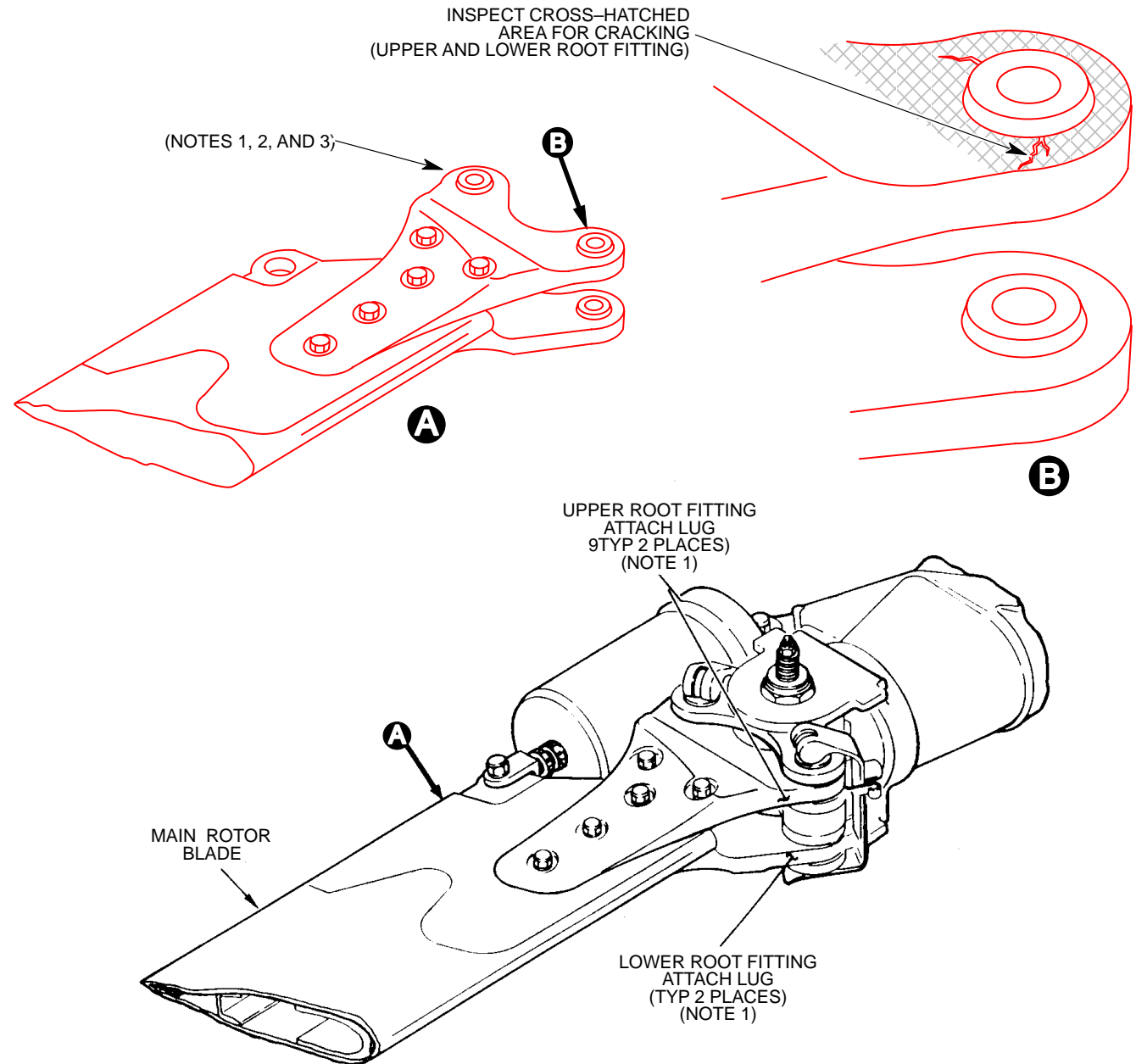

## NOTES

1. VISUALLY INSPECT AREAS OF ALL ROOT FITTINGS FOR CRACKS OR BREAKS. INSPECT BLADE ATTACH BUSHINGS FOR LOOSENESS.
2. PAY PARTICULAR ATTENTION TO AREA AROUND ATTACH PIN HOLES IN LUGS.
3. SEAL ALL JUNCTIONS BETWEEN BUSHINGS AND ATTACH LUGS WITH ZINC CHROMATE PRIMER, REFER TO MATERIALS TABLE.

88-672

**Figure 1. Inspection of main rotor blade root fitting attach lugs.**

MANDATORY MANDATORY MANDATORY